



SOUTH PUGET SOUND REGION FIREWOOD PERMIT

UNIT NAME: _____

Expiration Date: _____

**GENERAL PERMIT INFORMATION - YOU MUST PRINT, COMPLETE,
AND SIGN THIS PERMIT AND HAVE IT IN YOUR POSSESSION TO COLLECT FIREWOOD**

First Name: _____ Last Name: _____

Address: _____ City: _____ State: _____ Zip Code: _____

Phone # : _____

Vehicle License: _____ Make: _____ Model: _____

Year: _____ Vehicle Color: _____

Removal Location: _____ County: _____

IFPL Shut Down Zone: _____

Product: _____ Maximum Quantity (Cords): _____

Permit Fee (US Dollars): _____

NOTICES

- 1) **A valid Discover Pass is required to access all firewood units on DNR managed lands.** For information on how to purchase a pass, visit www.discoverpass.wa.gov or call 1-866-320-9933. To explore other recreation opportunities on DNR managed lands, visiting www.dnr.wa.gov/recreation.
- 2) **THIS FIREWOOD PERMIT MUST BE PROPERLY COMPLETED, SIGNED, AND DISPLAYED IN THE WINDSHIELD OF YOUR VEHICLE WHEN CUTTING AND HAULING FIREWOOD FROM STATE LAND.**
- 3) **TO REPORT A FOREST FIRE CALL 1-800-562-6010.** To report firewood theft, or cutting outside of a permit area, please call the South Puget Sound Region Office at 360-825-1631.
- 4) The Permittee agrees to hold DNR, and its agents, harmless for any and all damages to persons and/or property that may occur as a result of using this permit.
- 5) **VIOLATION OF THE TERMS AND CONDITIONS LISTED HEREIN MAY RESULT IN PERMIT FORFEITURE AND/OR CITATION.**

CLOSED SEASON

(April 15 thru October 15)

- 6) THE FOLLOWING CONDITIONS SHALL APPLY TO FIREWOOD GATHERING WITHIN THE CLOSED SEASON:
 - a. The closed season shall occur annually between **April 15 and October 15** unless modified by DNR.
 - b. The IFPL Shutdown Zone for this firewood unit is _____.
 - c. Power saw use is allowed only on days designated as a **PRECAUTION LEVEL 1**. Please call 1-800-527-3305 or visit <https://fortress.wa.gov/dnr/protection/ifpl/> to check the daily precaution level.

PERMIT CONDITIONS

- A. THIS PERMIT AUTHORIZES THE REMOVAL OF FIREWOOD FROM SPECIFIED DNR LANDS SUBJECT TO THE TERMS AND CONDITIONS OF THIS PERMIT.
- B. FIREWOOD MAY ONLY BE REMOVED FROM THE APPROVED UNIT(S) AS SHOWN ON THE ATTACHED MAP(S).
- C. ALL FIREWOOD MUST BE DOWN AND DEAD; REMOVAL OF STANDING TIMBER IS PROHIBITED.
- D. ALL FIREWOOD MUST BE LOCATED WITHIN _____ FEET OF AN ACTIVE ROAD OR LANDING.
- E. FIREWOOD CUTTING IS PROHIBITED WITHIN RIPARIAN MANAGEMENT ZONES.
- F. FIREWOOD CUTTING IS PROHIBITED WITHIN LEAVE TREE CLUMPS AND OTHER AREAS AS POSTED. TREES MARKED WITH PAINT SHALL BE LEFT IN PLACE AND MAY NOT BE CUT OR MOVED.
- G. All vehicles must stay on existing roads and/or landings.
- H. Vehicle use is prohibited in areas that have been abandoned or closed.
- I. Use of ATV's, ORV's, and/or motorized equipment (excluding power saws), is prohibited within the firewood unit.
- J. Mechanical yarding is prohibited on DNR land.
- K. The firewood unit may be closed, suspended, or terminated at any time as deemed necessary by DNR.
- L. Firewood is available on a first come, first serve basis only; DNR cannot guarantee the quantity/quality of firewood available.
- M. Firewood is intended for personal use only; the permit and/or firewood may not be traded or sold.
- N. This permit is valid for one household only and is non-transferable; each household may remove a *maximum of six (6) cords* of wood each calendar year from DNR land (RCW 79.15.420) regardless of how many permits are obtained.
- O. This permit is valid only for the person and vehicle listed on the permit.
- P. Smoking in logged areas is illegal and may cause a serious fire.
- Q. **THIS FIREWOOD UNIT CLOSSES ON _____.** No firewood shall be removed after this date.
- R. Firewood units will be open _____ days a week unless otherwise posted.
- S. Firewood units will be "open" daily from _____ to _____ unless otherwise posed. During the "closed" period, access to the firewood unit may be restricted through the use of gates and locks.

SIGNATURE

(This permit is not valid until signed.)

FIREWOOD PERMITTEE

Dated: _____

By: _____

STATE OF WASHINGTON
DEPARTMENT OF NATURAL RESOURCES

Dated: _____

By: _____
Authorized Signature for South Puget
Sound Region Manager



FIREWOOD PERMIT DRIVING MAP

SALE NAME: VESPA VRH & VDT

TOWNSHIP(S): T15R5E

REGION: South Puget Sound Region
COUNTY(S): Pierce
ELEVATION RGE: 2240-3000

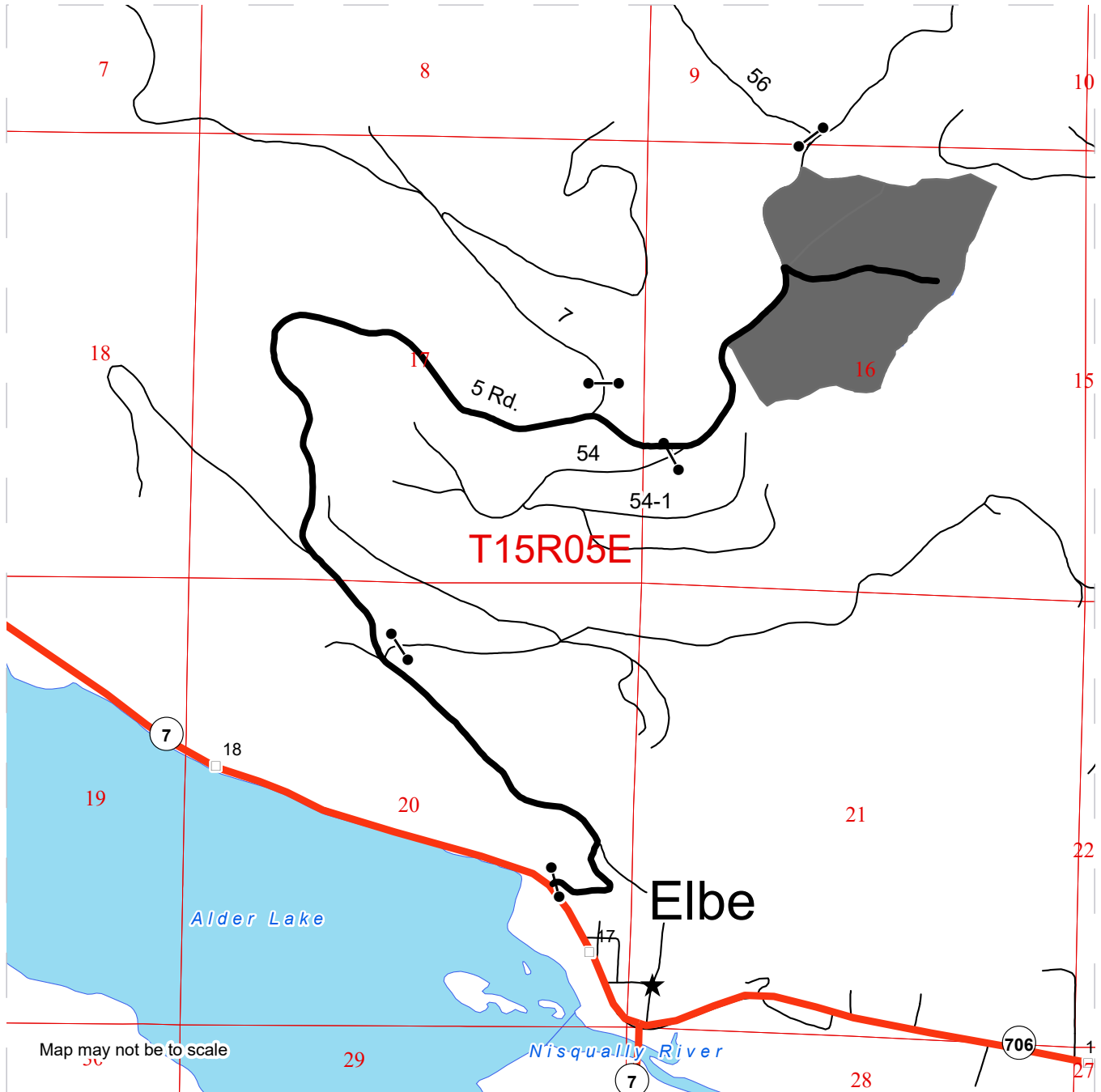

- Timber Sale Area
- Access Roads
- Highway
- Milepost Markers
- Gate
- Town

DRIVING DIRECTIONS:

From Elbe follow SR-7 to the west for approximately 0.2 miles. Turn right onto the 5 Rd. and follow for 3.4 miles to reach the permit area.

SEE NEXT MAP FOR SPECIFIC FIREWOOD PERMIT AREA!



FIREWOOD PERMIT MAP

SALE NAME: VESPA VRH & VDT

REGION: South Puget Sound Region

TOWNSHIP(S): T15R5E

COUNTY(S): Pierce

ELEVATION RGE: 2,240 - 3,000 feet

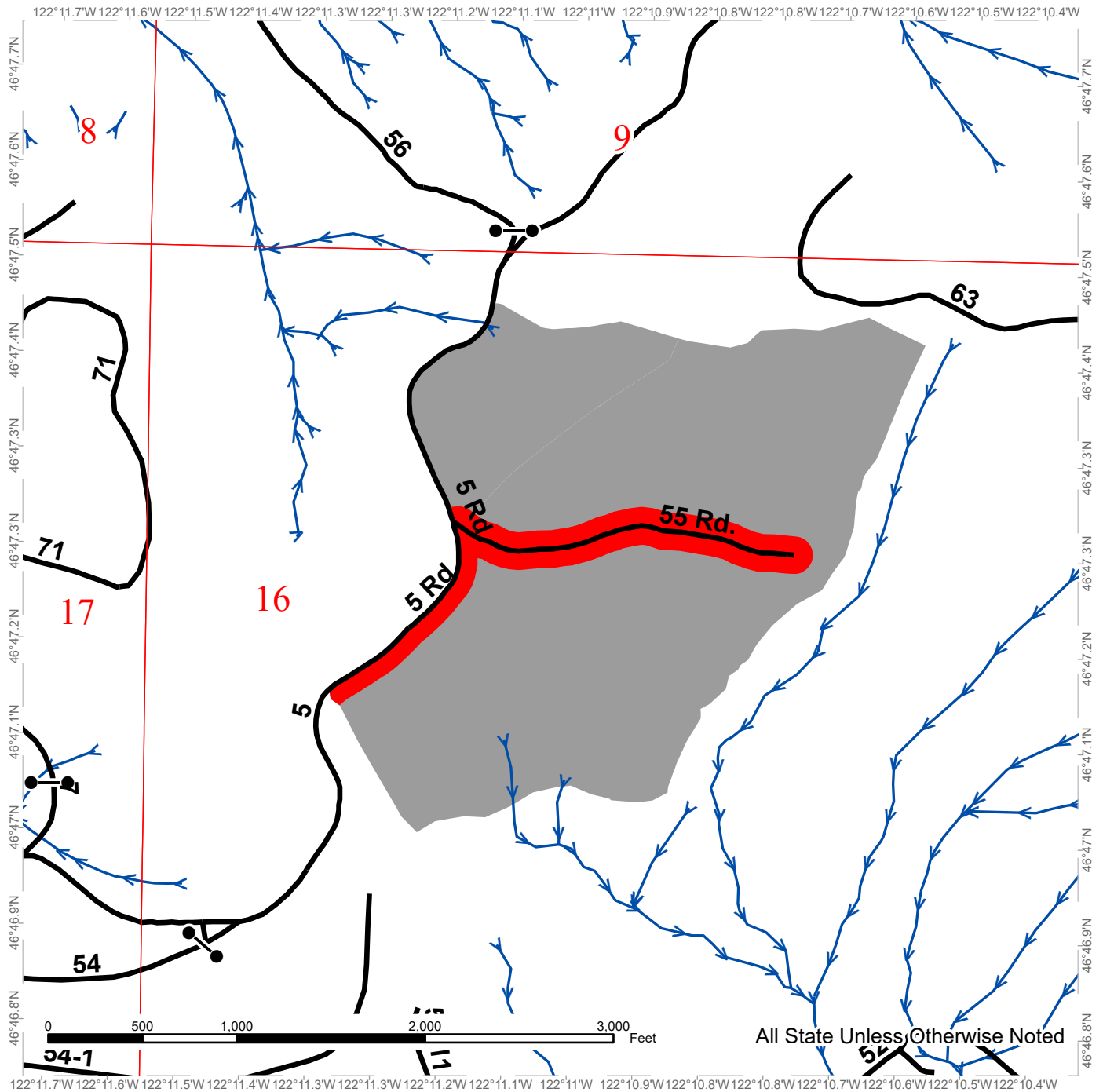

- Firewood Permit Area (Within 100' of the portions of the two roads highlighted in red)
- Timber Sale Area
- DNR Active Roads
- Streams
- Gate
- Public Land Survey Sections